

ENG

KNOG + POC

Knog x POC Helmet Light



WARNING: THIS LIGHT IS FOR HELMET USE ONLY AND MUST NOT REPLACE YOUR MAIN REAR BICYCLE LIGHT

CHARGING



Please recharge before first use!!

USB PLUG

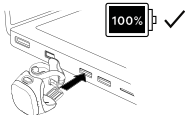

WALL PLUG

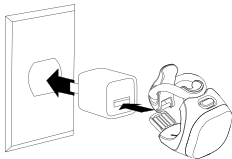

INTERFACE



1. POWER + MODE BUTTON
2. RECHARGE INDICATOR
3. LOW BATTERY INDICATOR

LONG PRESS 1 TO TURN LIGHT ON/OFF
SHORT PRESS 1 TO CYCLE MODES

MOUNTING

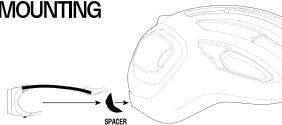

1. INSERT HELMET LIGHT WITH STRAP ATTACHED



2. ENGAGE THE HOOK INTO THE LATCH



THIS HELMET LIGHT IS NOT STVZO APPROVED

KNOG[®]

TECHNICALLY
UN@NVENTIONAL

DESIGNED IN NAARM [MELBOURNE] BY KNOG[®]
2 YEAR WARRANTY-DETAILS AT KNOG.COM

This device complies with Part 68 of the FCC Rules. Operation is subject to the following two conditions:
(1) This device may not cause harmful interference, and
(2) This device must accept any interference received, including interference that may cause undesired operation.